

EDITION	DESCRIPTION	DRAWN	DATE
	UPDATE DRAWING FORMAT		04/05/03

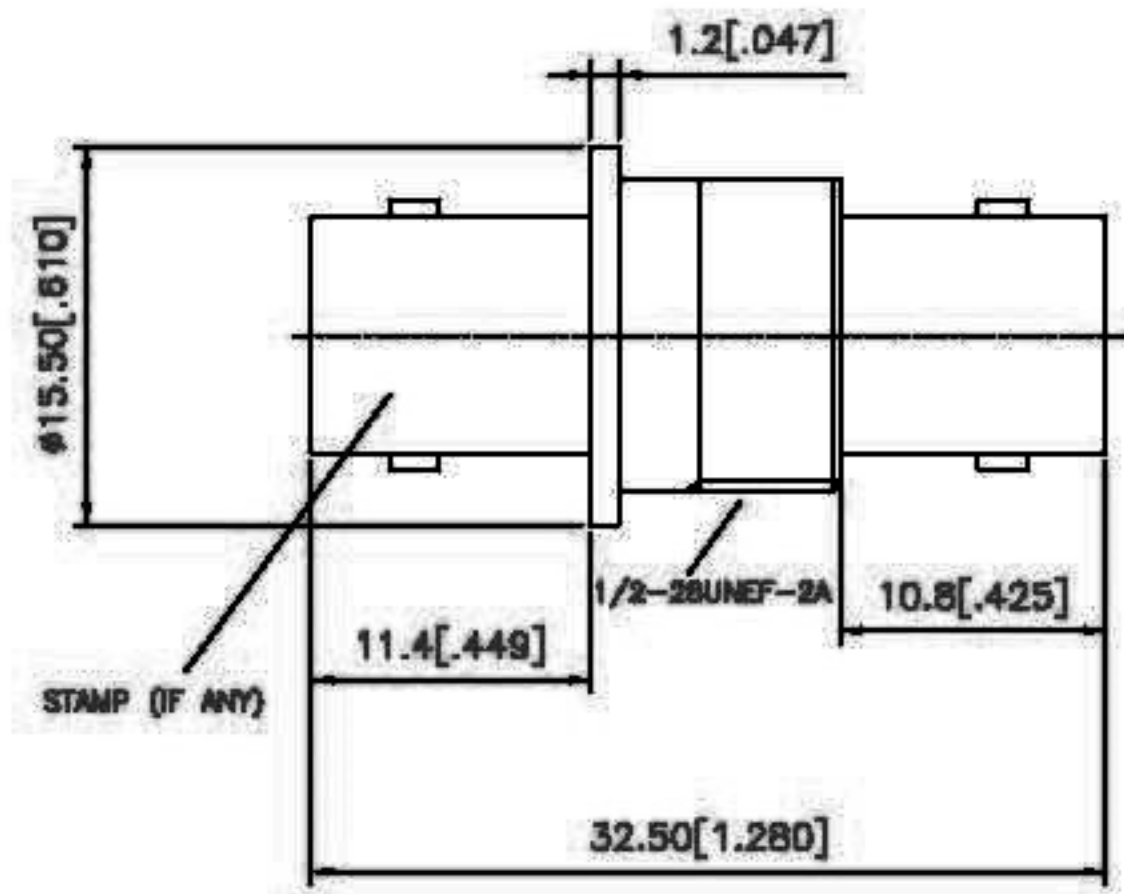

NOTE: 1. MAX. PANEL THICKNESS = 5.5mm

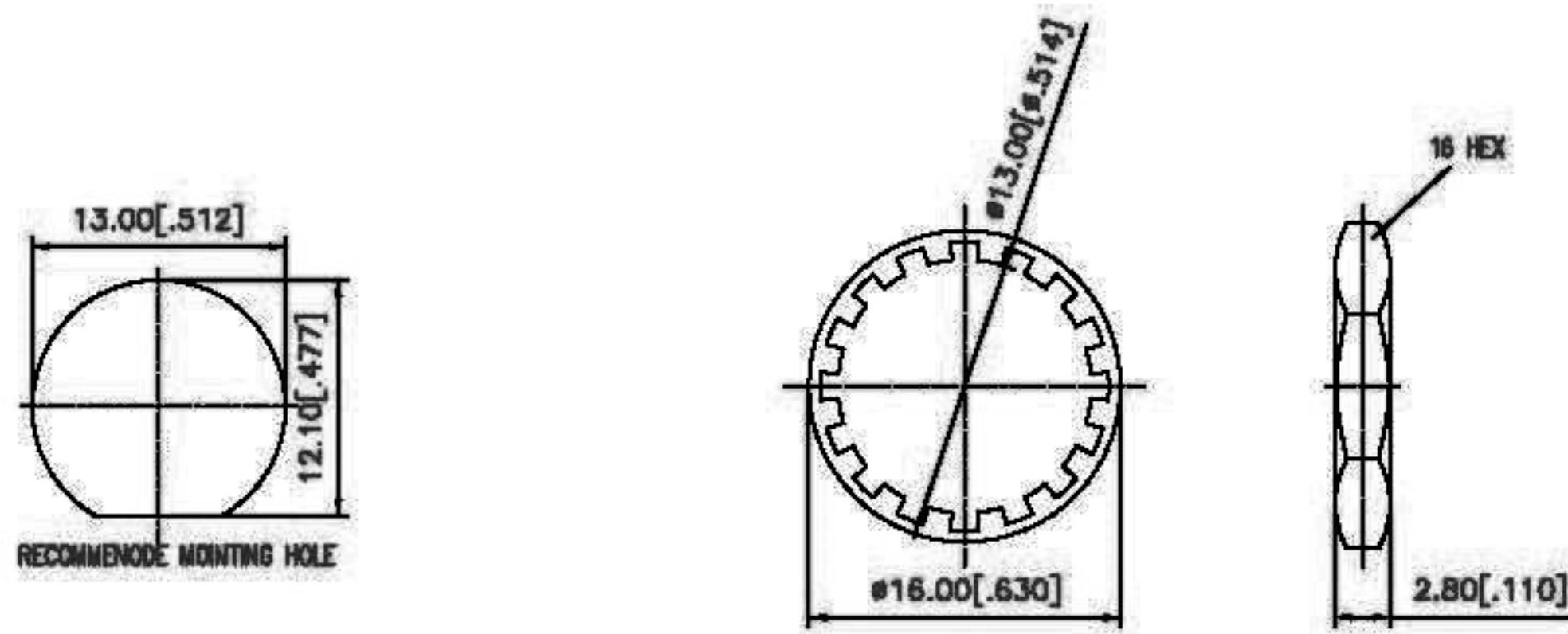

TOLERANCES	
DIMENSIONS ARE IN MILLIMETER	
UNLESS OTHERWISE SPECIFIED TOLERANCES FOR INCHES ARE 0.5-8mm±0.2mm 8-30mm±0.1mm 30-120mm±0.05mm UNLESS OTHERWISE SPECIFIED TOLERANCES FOR INCHES ARE .020-.315=±0.007" .315-1.180=±0.015" 1.180-4.724=±0.020"	

TITLE	BNC FEMALE TO FEMALE BULKHEAD ISOLATED ADAPTOR - 50 ohm	CHECKED	J. Lin
Edt Code.	BNCFBSBNCFADP5000-6	DRAWER	Eddie
FILE NO. C:	EDITION: A	DATE	04/05/03

NO	Description	Qty	Material	Finish
7	HEX NUT	1	BRASS	NICKEL
6	LOCK WASHER	1	BRASS	NICKEL
5	LOCK RING	1	BRASS	NICKEL
4	CONTACT PIN	1	PHOS.BRONZE	GOLD
3	INSULATOR	1	DELIN	NATURAL
2	INSULATOR	1	DELIN	WHITE
1	BODY	1	BRASS	NICKEL